

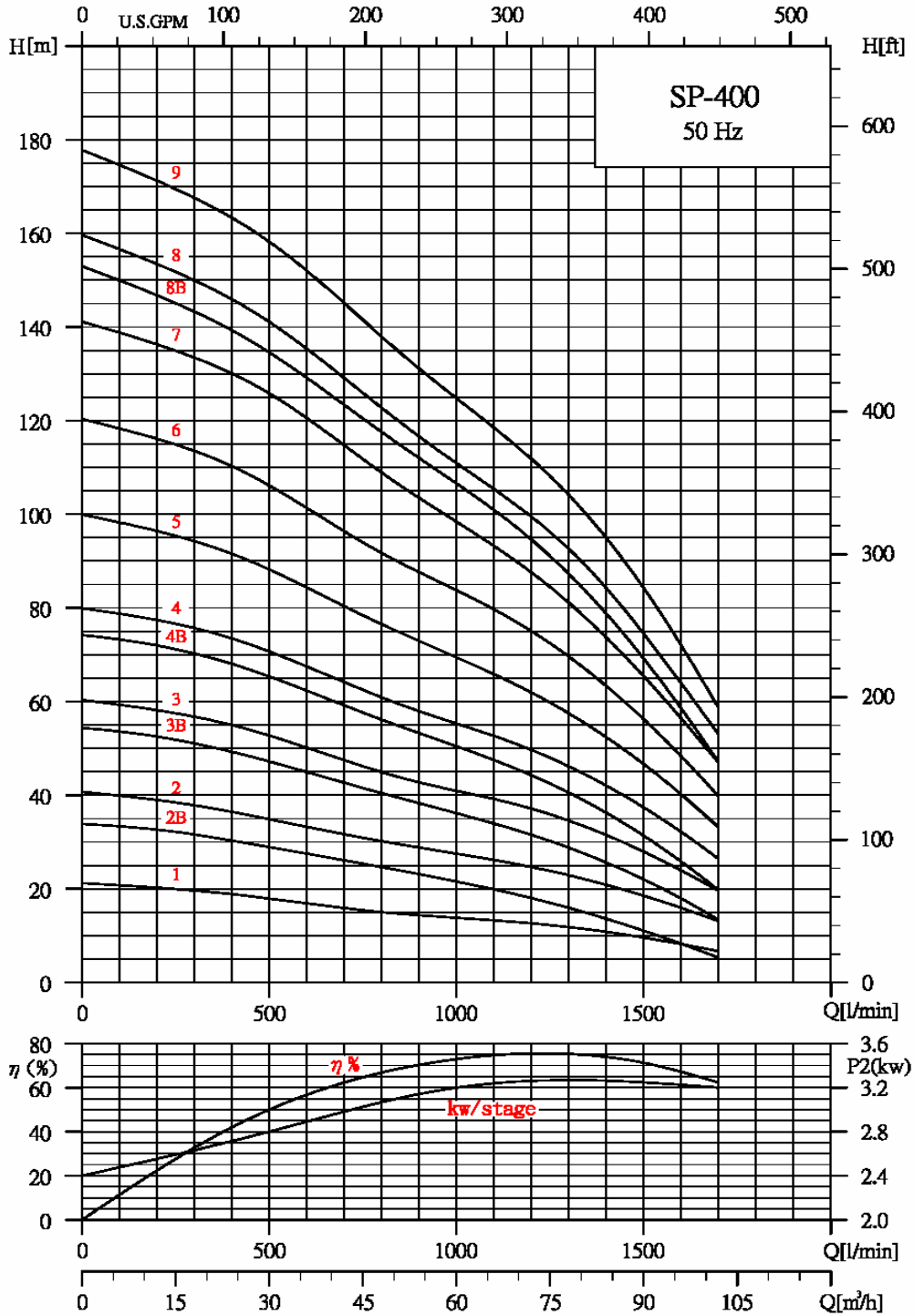

## Performance Curves

## SP-400



1	13/10/2005
No.	Date



## Performance Curves

## SP-400

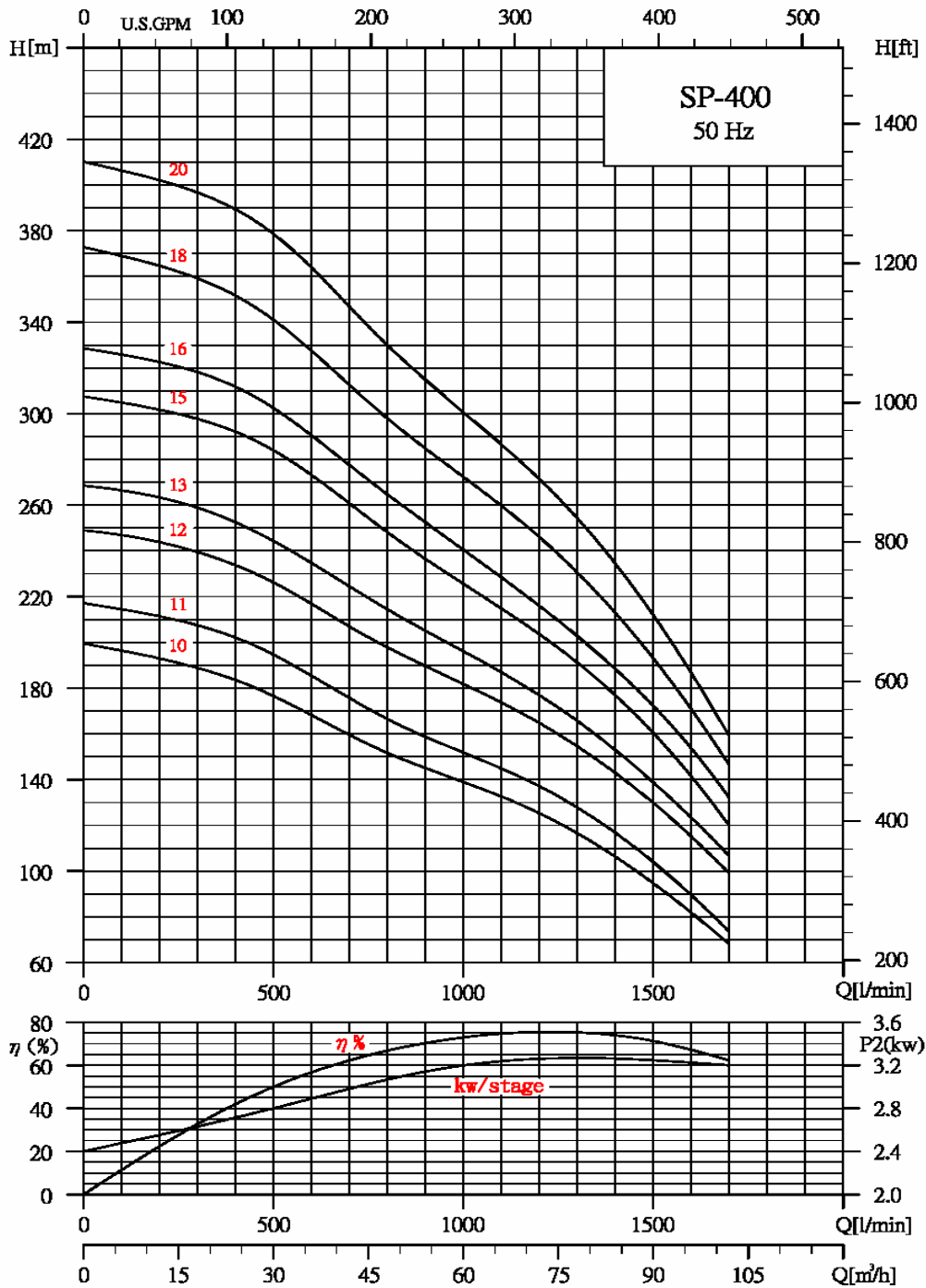

1	13/10/2005
No.	Date



## SELECTION CHART

50 HZ

Pump Type	Motor P2		Max.current Amp		Q capacity 2900 rpm												
					$m^3/h$	12	18	24	30	36	42	48	54	66	78	90	102
	KW	HP	220V	380V	1/min	200	300	400	500	600	700	800	900	1100	1300	1500	1700
SP 400-1	5.5	7.5	21.9	12.7	HEAD IN METERS	20	19.5	19	18	17	16	15	14	13	12	9	7
SP 400-2-B	5.5	7.5	21.9	12.7		33	32	30	28	27	26	25	23	20	16	11	6
SP 400-2	7.5	10	28.5	16.5		39	38	37	35	33	32	30	28	26	23	18	13
SP 400-3-B	9.3	12.5	36	20.9		53	51	49	47	45	43	41	38	34	28	22	13
SP 400-3	11	15	41.8	24.2		58	57	55	53	50	47	45	43	39	35	28	20
SP 400-4-B	13	17.5	50	29		72	70	68	65	62	59	56	53	47	40	31	20
SP 400-4	15	20	55	32		77	76	74	71	67	64	61	58	53	46	37	27
SP 400-5	18.5	25	69	40		96	94	92	88	84	80	76	73	66	57	46	33
SP 400-6	22	30	81	47		116	113	110	106	101	96	92	88	80	70	56	40
SP 400-7	26	35	96	56		136	133	130	126	120	115	109	104	93	81	65	47
SP 400-8-B	26	35	96	56		147	143	139	134	129	123	117	112	101	87	69	47
SP 400-8	30	40	111	64		153	150	146	141	135	129	123	117	105	93	75	53
SP 400-9	30	40	111	64		171	167	163	158	152	145	138	131	118	104	84	58
SP 400-10	37	50	138	80		193	188	183	177	168	160	152	145	132	117	94	68
SP 400-11	37	50	138	80		211	207	202	195	186	176	167	159	145	128	104	74
SP 400-12	45	60	154	89		244	240	234	227	217	207	198	190	173	154	130	99
SP 400-13	55	75	192	111		263	259	252	244	235	224	214	205	187	166	139	107
SP 400-15	55	75	192	111		302	298	292	284	273	260	248	237	215	191	160	120
SP 400-16	63	85	240	139		322	318	312	302	290	278	265	252	228	202	172	132
SP 400-18	63	85	240	139		365	359	352	341	328	312	298	285	260	230	193	147
SP 400-20	75	100	256	148	402	397	389	379	364	347	330	315	287	254	212	159	



## DIMENSIONS AND WEIGHTS

Pump Type	Dimensions(mm)										Net weight (Kg)	
	5" Connection (RP,NPT)					5" Flange						
	A	B	C	E*	E**	A	B	C	E*	E**	Pump	Motor
SP 400-1	1232	614	618	178	186	1232	614	618	200	200	25.1	48
SP 400-2-B	1360	614	746	178	186	1360	614	746	200	200	28.7	48
SP 400-2	1392	646	746	178	186	1392	646	746	200	200	28.7	52
SP 400-3-B	1585	711	874	178	186	1585	711	874	200	200	32.3	58
SP 400-3	1585	711	874	178	186	1585	711	874	200	200	32.3	58
SP 400-4-B	1779	776	1003	178	186	1779	776	1003	200	200	35.9	64
SP 400-4	1779	776	1003	178	186	1779	776	1003	200	200	35.9	64
SP 400-5	1972	841	1131	178	186	1972	841	1131	200	200	39.5	70
SP 400-6	2165	906	1259	178	186	2165	906	1259	200	200	43	76
SP 400-7	2423	1036	1387	178	186	2423	1036	1387	200	200	46.6	92
SP 400-8-B	2551	1036	1515	178	186	2551	1036	1515	200	200	50.2	92
SP 400-8	2551	1036	1515	178	186	2551	1036	1515	200	200	50.2	92
SP 400-9	2680	1036	1644	178	186	2680	1036	1644	200	200	53.8	92
SP 400-10	3177	1405	1772	178	186	3177	1405	1772	200	200	57.4	136
SP 400-11	3305	1405	1900	178	186	3305	1405	1900	200	200	61	136
SP 400-12	3101	1062	2039	200	204	3101	1062	2039	209	209	66	175
SP 400-13	3372	1204	2168	200	204	3372	1204	2168	209	209	69.6	193
SP 400-15	3628	1204	2424	200	204						76.8	193
SP 400-16	4185	1633	2552	200	204						80.4	249
SP 400-18	4442	1633	2809	200	204						87.6	249
SP 400-20	4459	1394	3065	200	204						94.8	213

E\* : Maximum diameter of pump with one motor cable

E\*\* : Maximum diameter of pump with two motor cable

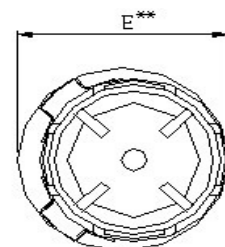
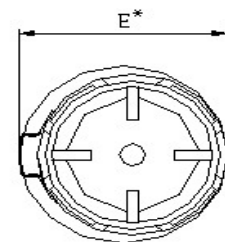
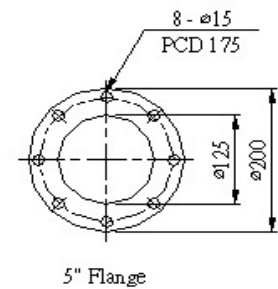
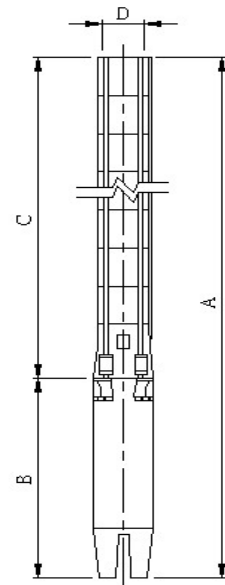



Performance Curves

SP-500

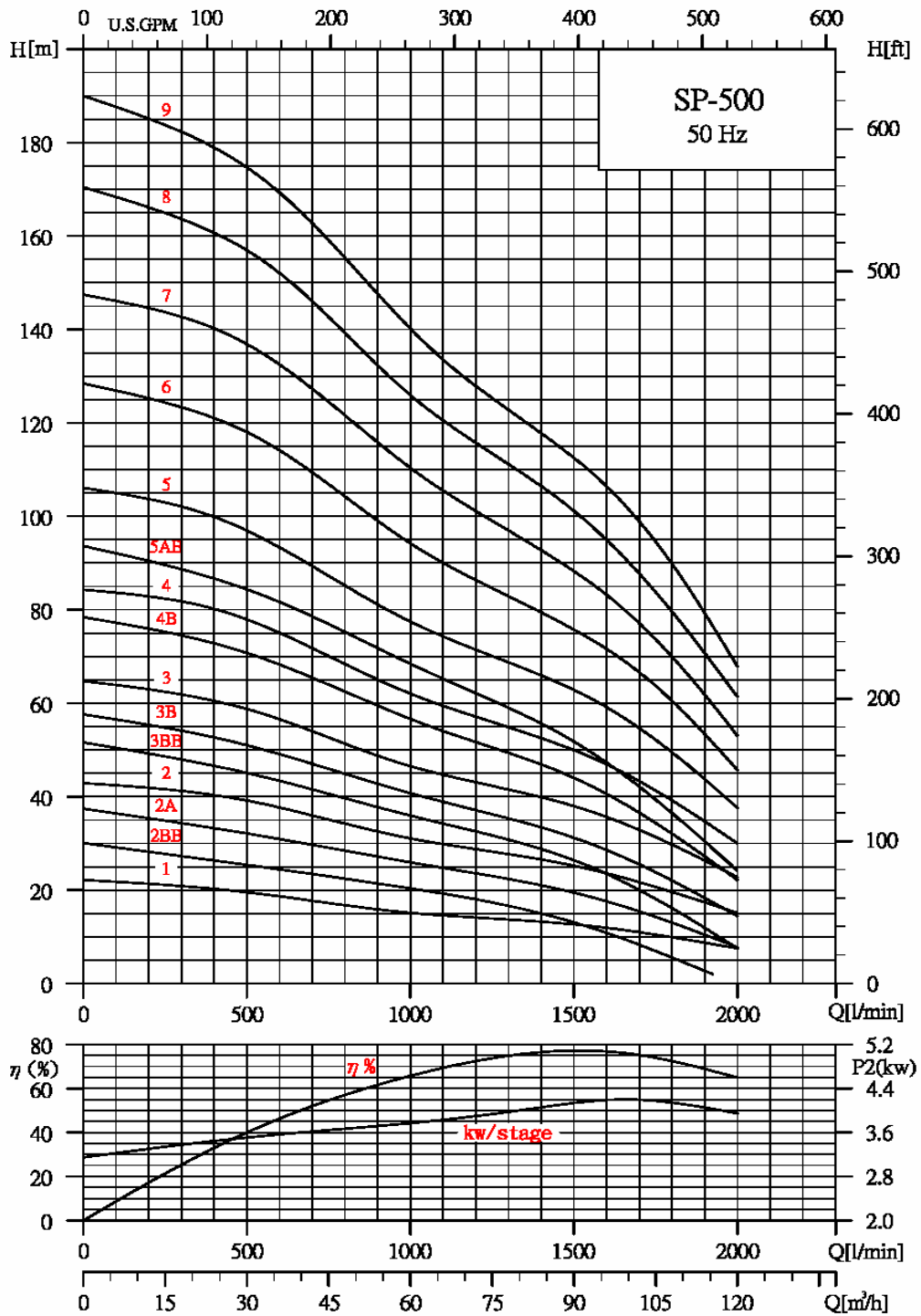

1	10/11/2005
No.	Date



Performance Curves

SP-500

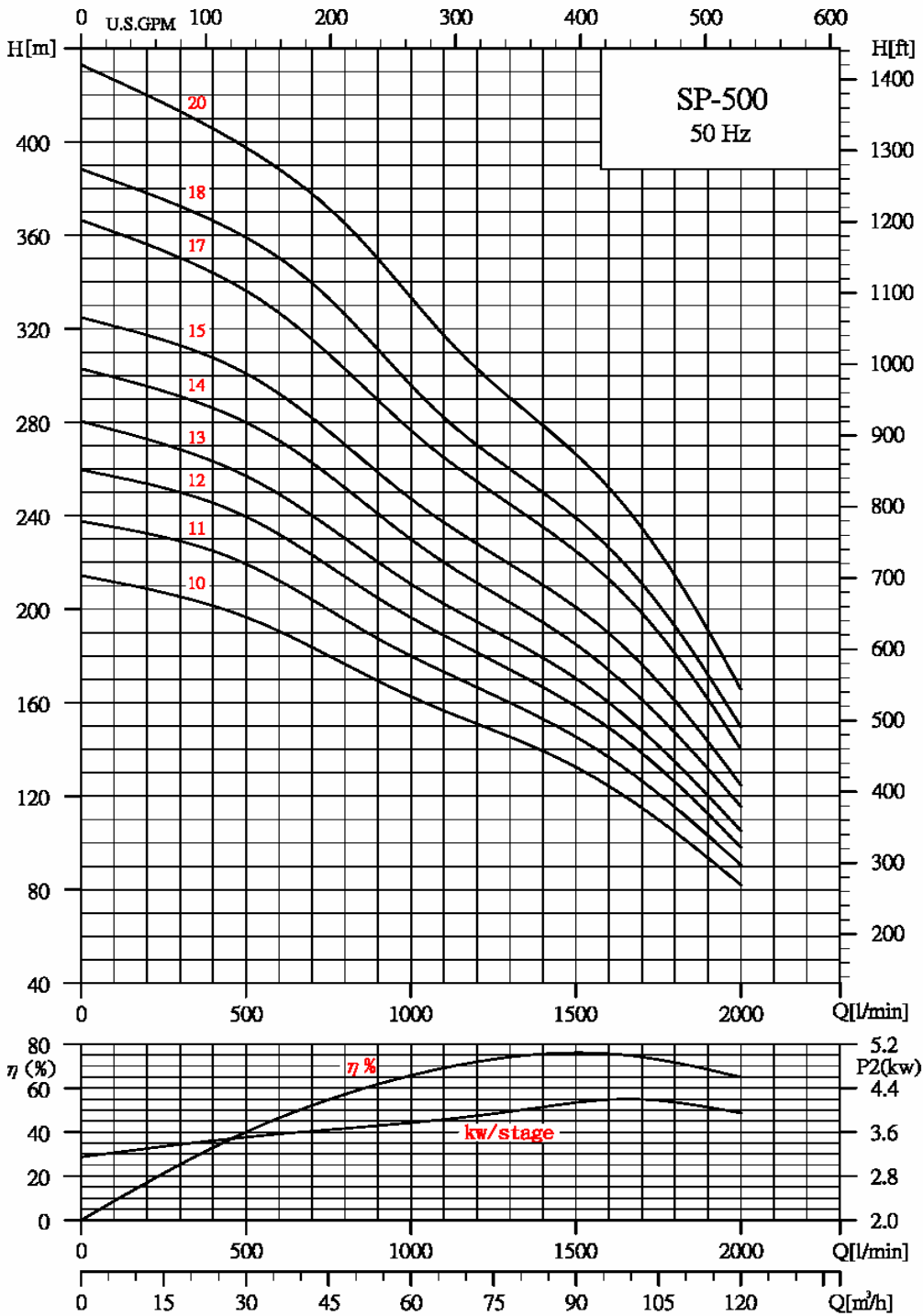

1	10/11/2005
No.	Date



## SELECTION CHART

50 HZ

Pump Type	Motor P2		Max.current Amp		Q capacity 2900 rpm													
					$m^3/h$	18	24	30	36	42	48	60	72	84	96	108	120	
	KW	HP	220V	380V	1/min	300	400	500	600	700	800	1000	1200	1400	1600	1800	2000	
SP 500-1	5.5	7.5	21.9	12.7	HEAD IN METERS	21	20	19	18	17.5	17	15	14	13	12	10	8	
SP 500-2-BB	5.5	7.5	21.9	12.7		27	26	25	24	23	22	20	18	15	11	5	0	
SP 500-2-A	7.5	10	28.5	16.5		34	33	32	31	30	28	26	24	21	17	13	8	
SP 500-2	9.3	12.5	36	20.9		41	40	39	37	36	34	31	29	26	23	20	15	
SP 500-3-BB	9.3	12.5	36	20.9		48	46	45	43	41	40	36	33	28	23	16	8	
SP 500-3-B	11	15	41.8	24.2		54	53	51	49	47	45	41	37	33	28	22	15	
SP 500-3	13	17.5	50	29		62	60	59	57	54	51	47	43	40	35	30	23	
SP 500-4-B	15	20	55	32		74	73	71	68	65	62	56	52	47	40	32	22	
SP 500-4	18.5	25	69	40		82	80	78	75	72	68	62	57	53	47	39	30	
SP 500-5-AB	18.5	25	69	40		89	87	84	82	78	75	68	62	55	47	36	25	
SP 500-5	22	30	81	47		102	100	97	94	90	85	77	72	66	59	50	38	
SP 500-6	26	35	96	56		123	121	118	114	110	104	94	86	79	72	60	46	
SP 500-7	30	40	111	64		143	140	137	132	127	121	110	101	93	83	70	53	
SP 500-8	37	50	138	80		164	160	157	152	146	139	126	116	106	95	80	62	
SP 500-9	37	50	138	80		182	179	175	169	163	155	140	128	118	106	90	68	
SP 500-10	45	60	154	89		206	201	197	190	183	177	162	150	140	124	105	82	
SP 500-11	55	75	192	111		230	225	220	212	204	196	180	167	152	137	116	90	
SP 500-12	55	75	192	111		250	245	240	231	222	214	197	181	167	150	126	99	
SP 500-13	55	75	192	111		268	263	258	250	240	230	210	195	180	160	135	106	
SP 500-14	63	85	240	139		291	286	280	271	261	251	230	210	194	174	147	116	
SP 500-15	75	100	256	148	312	308	300	292	281	270	248	228	210	190	160	126		
SP 500-17	75	100	256	148	350	344	336	327	316	302	277	255	235	212	180	140		
SP 500-18	93	125	335	194	372	366	360	350	340	326	296	270	250	227	192	150		
SP 500-20	93	125	335	194	412	406	397	388	378	365	333	302	279	251	214	166		



## DIMENSIONS AND WEIGHTS

Pump Type	Dimensions(mm)										Net weight (Kg)	
	5" Connection (RP,NPT)					5" Flange						
	A	B	C	E*	E**	A	B	C	E*	E**	Pump	Motor
SP 500-1	1232	614	618	178	186	1232	614	618	200	200	25.1	48
SP 500-2-BB	1360	614	746	178	186	1360	614	746	200	200	28.7	48
SP 500-2-A	1392	646	746	178	186	1392	646	746	200	200	28.7	52
SP 500-2	1457	711	746	178	186	1457	711	746	200	200	28.7	58
SP 500-3-BB	1585	711	874	178	186	1585	711	874	200	200	32.3	58
SP 500-3-B	1585	711	874	178	186	1585	711	874	200	200	32.3	58
SP 500-3	1650	776	874	178	186	1650	776	874	200	200	32.3	64
SP 500-4-B	1779	776	1003	178	186	1779	776	1003	200	200	35.9	64
SP 500-4	1844	841	1003	178	186	1844	841	1003	200	200	35.9	70
SP 500-5-AB	1972	841	1131	178	186	1972	841	1131	200	200	39.5	70
SP 500-5	2037	906	1131	178	186	2037	906	1131	200	200	39.5	76
SP 500-6	2295	1036	1259	178	186	2295	1036	1259	200	200	43	92
SP 500-7	2423	1036	1387	178	186	2423	1036	1387	200	200	46.6	92
SP 500-8	2920	1405	1515	178	186	2920	1405	1515	200	200	50.2	136
SP 500-9	3049	1405	1644	178	186	3049	1405	1644	200	200	53.8	136
SP 500-10	2845	1062	1783	196	204	2845	1062	1783	205	205	58.8	175
SP 500-11	3115	1204	1911	196	204	3115	1204	1911	205	205	62.4	193
SP 500-12	3243	1204	2039	196	204	3243	1204	2039	205	205	66	193
SP 500-13	3372	1204	2168	196	204	3372	1204	2168	205	205	69.6	193
SP 500-14	3929	1633	2296	196	204	3929	1633	2296	205	205	73.2	249
SP 500-15	3818	1394	2424	196	204						76.7	213
SP 500-17	4074	1394	2680	196	204						84	213
SP 500-18	4557	1748	2809	196	204						87.6	318
SP 500-20	4813	1748	3065	196	204						94.8	318

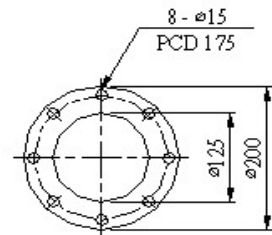
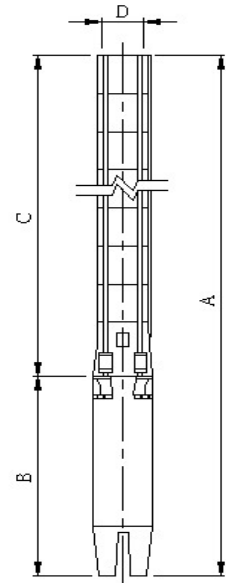

5" Flange

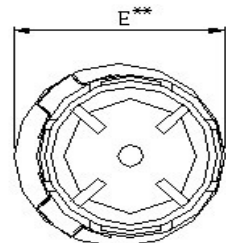
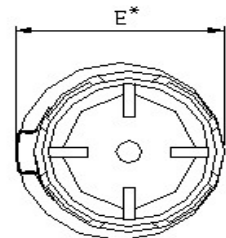

E\* : Maximum diameter of pump with one motor cable  
 E\*\* : Maximum diameter of pump with two motor cable